

LDM-1225 NEON Light Strip

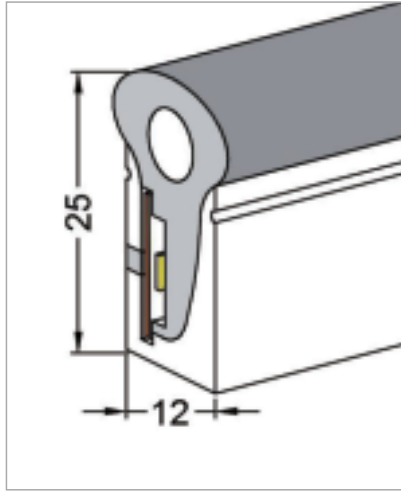

PCB Width(MM)	12
Voltage(V)	24V
Power (W/M)	12
CCT (K)	3000K±150 4000K±250 6500K±450 RGB
Luminous (LM)	480-7
Luminous Efficiency (LM/W)	20 40
CRI (RA)	>80
Size(MM)	12X25mm
Working Temperature	-20~50 °C
IP Grade	IP67

Structure & Introduction

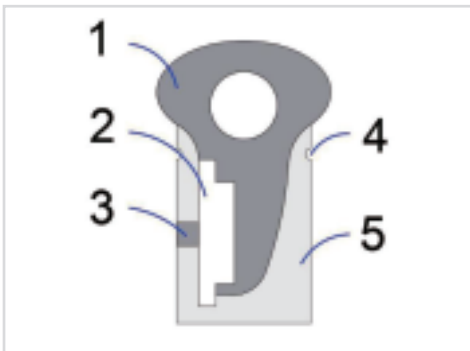

Side View

1. Mushroom Type Luminous Surface:	Uniform and soft , no light spot
2. PCB:	Width: 12mm LED Qty≥60/pcs LED Type: 5050
3.Cutting Point :	Visible
4.Fixer Notch :	Fix strip by clips
5.Light Diffusion Hole:	Diffuse and refract light

IP67

Product Features

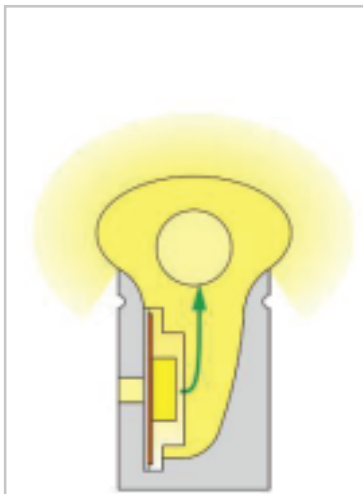

- Professional structural design ensures uniform and soft luminance without light spots.
- Silicone glue is anti-yellowing and heat-resistant, suitable for outdoor environments.
- Anti-corrosive properties allow for use in harsh environments, including exposure to acid and alkali.
- Exhibits excellent waterproof performance.
- Offers outstanding flexibility for optional shaping.

Installation Accessories



Left outlet plug



Straight outlet plug

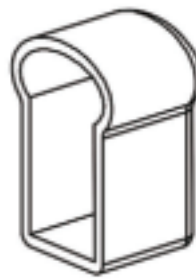

End Cap

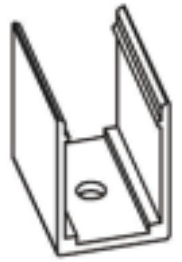

Fixed clip

Installation Instructions

Cutting Method

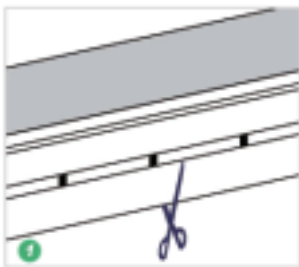

1 Cut along the black marker on the side of the LED strip.

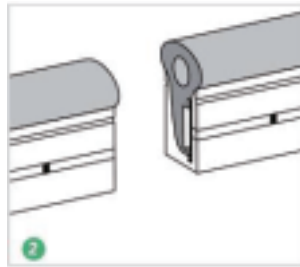

2 Finished the cutting

(Left Outlet Plug) Plug installation method



1 Prepare plug and wire

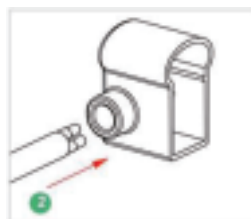

2 Place the wire in the indicated direction.



3 After wearing it

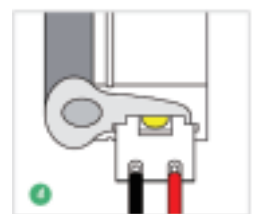

4 Solder the wire to the bare board, with the red wire connected to the anode and the black negative wire connected to the cathode.

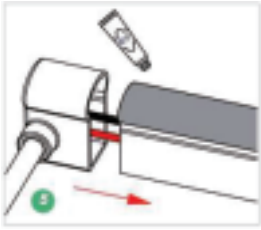

Apply glue to the section, then insert it into the plug following the direction of the arrow.

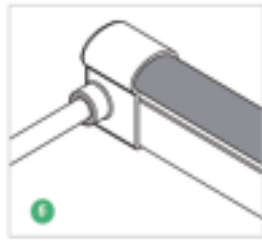

After installation, avoid moving it for 2 to 3 hours, and wait for 12 hours before packing.

(Straight Outlet Plug) Plug installation



Prepare plug and wire

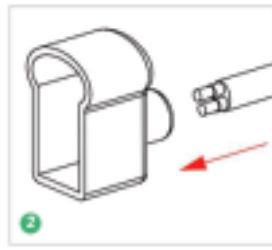

Place the wire in the indicated direction.

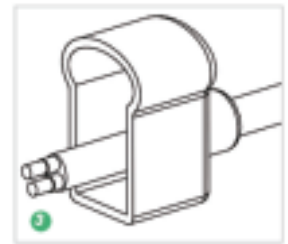

After wearing it

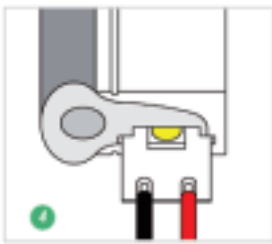

Solder the wire to the bare board, with the red wire connected to the anode and the black negative wire connected to the cathode.

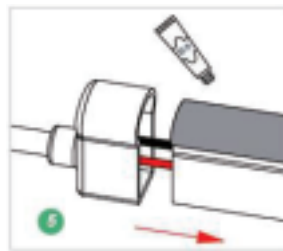

Apply glue to the section, then insert it into the plug following the direction of the arrow.

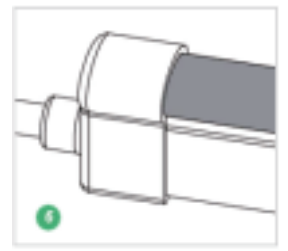

After installation, avoid moving it for 2 to 3 hours, and wait for 12 hours before packing.

(End plug) Installation method

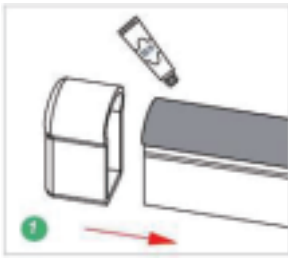

Apply glue to the end of the casing and install the plug in the direction of the arrow.

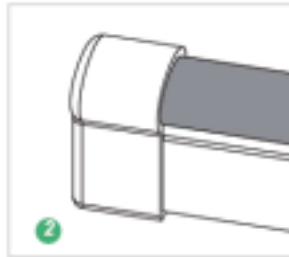

After installing, it can't be moved until 2~3 hours, and 12 hours for packing

(Fixed clip) Installation method



Prepare Screws and fixed clips



Put the clips on a proper position and insert the screw to fix it

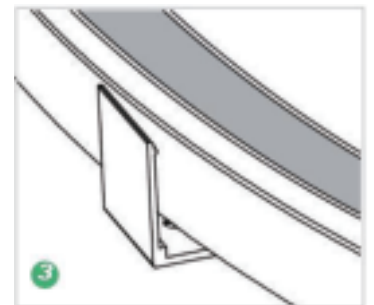

Put the light surface of the lamp ,
Upside, gently apply force

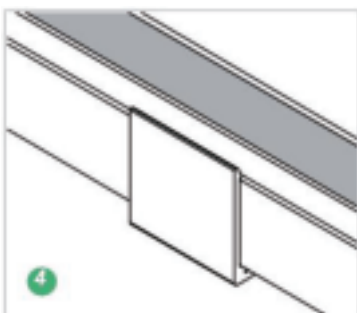

The installation is complete

Precautions

When installing the light strip, please be aware that the strips have limited flexibility in bending direction. To prevent damage to the light bar, please adhere to the specified shape and degree as outlined in the following instructions.

correct

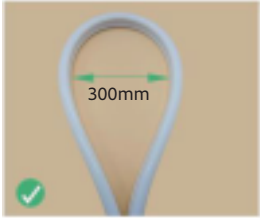

When facing the light surface, fold the strip with a minimum bending diameter of 300mm.



Five meters per roll, The package (reel) is cut inward, as illustrated, with a minimum bending diameter of 400mm.

LED strips are low-voltage products, necessitating the use of a power supply (transformer). Avoid directly connecting the LED strip to AC 110v or AC 220v, as this could result in LED strip burnout and pose safety risks.

Please read the specifications thoroughly before installation by professional staff to make sure the safe use.

Attention:: When packaging longer light strips, ensure that the inner diameter is larger to prevent damage to the PCB board inside.

Incorrect bending way



Facing the side surface (as shown in the picture), avoid bending downward to prevent damage to the strip.



Facing the side surface (as shown in the picture), avoid bending upward to prevent damage to the strip.

The PCB inside the bushing is mounted sideways and can only be bent in that direction.

