

# LED ECO Gimbal Downlight



## Key Features

- 4" LED ECO gimbal downlight with integral driver in connection box
- Type IC rated-no housing needed
- Flexibility to switch color temperature during installation to suit a specific application, just adjust the color temperature with the slide switch located inside the junction box
- Superior LED performance and lifespan
- **30° tilting, 180° rotation**
- LED source SDCM<5
- Cut hole in ceiling and snap fixture in opening with attached spring clips
- **Enjoy the benefits of voltage surge protection, reliable operation in low-temperature environments and longer driver lifetime**

## Dimensions

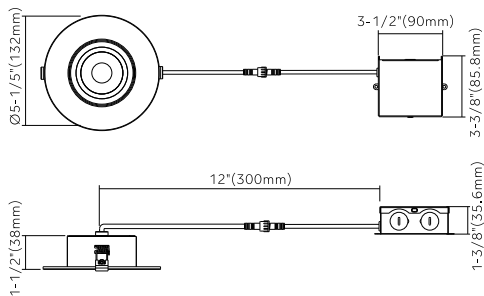

| Specifications       |   |
|----------------------|---|
| Models               | HB-GRF49W-CCT                             |
| Applications         | Sloped ceiling, highlighting artwork      |
| Wattage              | 9W  |
| Color Temperature(K) | 3CCT<br>3000/4000/5000                    |
| Delivered Lumen(lm)  | 750                                       |
| Halogen Equivalent   | 70W                                       |
| Beam Angle           | 38°                                       |
| CRI                  | >90                                       |
| Driver Input         | 120V AC                                   |
| Power Factor         | 0.9                                       |
| Dimming              | TRIAC dimmers 100%-10%                    |
| Cut out              | Ø3-3/4" (95mm)                            |
| Approved Location*   | Insulated ceiling, Indoor & Damp location |
| Ambient Temperature  | -20°C to +40°C                            |
| Air Tight            | Yes                                       |
| Projected Life       | 70% light output at 50,000 hours          |
| Certification        | cETLus                                    |
| Warranty*            | 5-year limited warranty                   |

\* Due to continuous improvements and innovations, specifications may change without notice

## 120V Input Driver Included



## Accessories

### AC120V driver



Model: LR-D120-09SB  
(Steel version)

### Rough-in plate

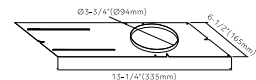

Model: HB-MP-35

### Extension cables (3pin)



Model: LR-EXC6-S3 6' 3pin cable  
LR-EXC10-S3 10' 3pin cable  
LR-EXC20-S3 20' 3pin cable

## Ordering Guide

Example: HB-GRF49W-CCTWH

| Series                         | Wattage | Color Temperature       | Voltage              | Finish   |
|--------------------------------|---------|-------------------------|----------------------|--|
| HB-GRF4 Recessed ECO Gimbal-4" | 9W      | CCT (3000K/4000K/5000K) | (Blank)<br>120V only | <ul style="list-style-type: none"> <li>● WH (White)</li> <li>● BK (Black)</li> </ul> |

\* Other finish are available, please contact our sales to make order for special items