

LED Gimbal Recessed Lights

4" Round



Key Features

- 4" round LED recessed gimbal with integral driver in connection box
- Eyeball, round & square models
- Type IC rated-no housing needed
- Flexibility to switch color temperature during installation to suit a specific application, just adjust the color temperature with the slide switch located on the junction box
- Superior LED performance and lifespan
- 30° tilting, 360° rotation
- Cut hole in ceiling and snap fixture in opening with attached spring clips
- Aluminum construction

Dimensions

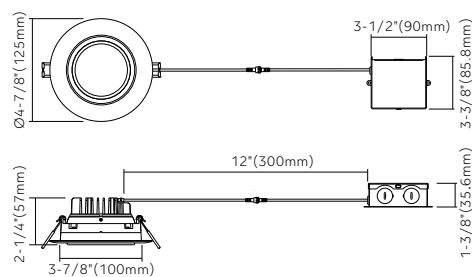

Ordering Guide

Series	Wattage	Color Temperature	Voltage	Finish
HB-S Recessed Gimbal -4" Round	11W	3000K	(Blank) 120V only	● WH (White)

Specifications

Models	HB-S11W-3KWH
Applications	Sloped ceiling, highlighting artwork
Wattage	11W
Color Temperature(K)	3000
Lumen Output(lm)	1000
Halogen Equivalent	100W
Beam Angle	40°
CRI	80
Driver Input	120V AC
Power Factor	0.9
Dimming	TRIAC dimmers 100%-10%
Cut out	4-1/4" (108mm)
Approved Location*	Insulated ceiling, Indoor & Wet location
Ambient Temperature	-20°C to +40°C
Air Tight	Yes
Projected Life	70% light output at 50,000 hours
Certification	cETLus
Warranty*	5-year warranty

Approved Location*-please contact our sales for outdoor application

Warranty*-refer to Hi-bright warranty policy

120V Input Driver Included



Accessories

Rough-in plate

Model: LR-RPU-H
Special item, please contact our sales

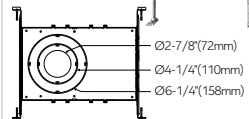

Model: LR-RPU

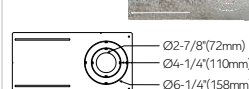

AC120V driver



Model: LR-D120-12SB
(Steel version)

Extension cables (3pin)



Model: LR-EXC6-S3 6' 3pin cable
LR-EXC10-S3 10' 3pin cable
LR-EXC20-S3 20' 3pin cable